



Costarena PH E-302

NEW DEVELOPMENT

CLUB CAMPESTRE - SAN JOSE DEL CABO



This spectacular
two-bedroom
penthouse
makes Baja
indoor-outdoor
living easy.

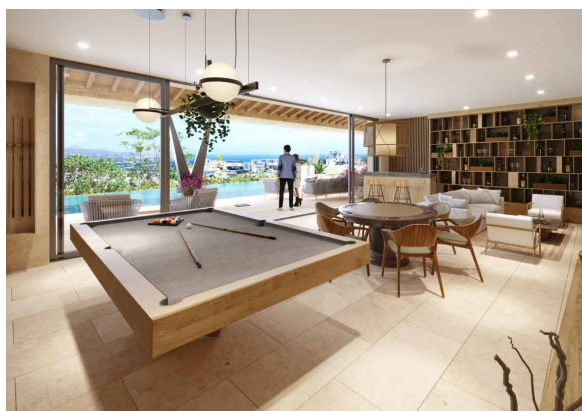

Overlooking the mountains and Punta Gorda, 1,445.28 square feet of luxury living spaces are beautifully appointed with custom white oak carpentry, Italian porcelain floors and double-glazed floor-to-ceiling windows. Entertain from the expansive open-concept living and dining areas that flow seamlessly onto a large terrace or from the 510 square-foot private rooftop terrace. A fully equipped Italian kitchen is complete with luxury appliances and a built-in breakfast bar. The spacious primary bedroom features a beautifully designed walk-in closet, an ensuite bathroom with dual vanities, and direct access to the terrace. The additional ensuite bedroom offers privacy at the back of the residence. Two parking spaces are included in the purchase, with ample room for a golf cart or storage and conveniently accessed by elevator.

\$489,000 USD

MLS: 22-3561 | 2 BEDS | 2.5 BATHS | 1,455.28 AC SF | 2,441.44 TOTAL SF